

PRICELIST & SPECIFICATION



LOA	approx.	11.32 m	37' 2"
Hull length	approx.	10.60 m	34' 9"
LWL	approx.	10.29 m	33' 9"
Beam	approx.	3.99 m	13' 1"
Draft			
T-keel, medium	approx.	2.13 m	7' 0"
Displacement			
T-keel, medium	approx.	8.37 t	18,453 lbs
Engine			
Diesel-standard	approx.	29.00 PS	29.00 hp
Diesel-option	approx.	39.00 PS	39.00 hp
Electric 18kW/h	approx.	25 kW	25 kW
Electric 36kW/h	approx.	25 kW	25 kW
Fuel tank	approx.	160 l	42 gal
Fresh water	approx.	345 l	91 gal
Mast length above WL	approx.	17.60 m	57' 9"
Total sail area	approx.	73.00 m ²	787 sq ft
Main sail	approx.	40.00 m ²	431 sq ft
Self-tacking jib	approx.	28.00 m ²	301 sq ft
Genoa	approx.	33.00 m ²	355 sq ft
Crossover	approx.	71.00 m ²	764 sq ft
Gennaker	approx.	112.00 m ²	1,206 sq ft

CE Certificate	A-6
Design	Berret - Racoupeau
Interior	Berret - Racoupeau

360ST

All measurements/figures are approximate. Errors and omissions excepted. All weights are specified in MLC. Specification and material can be changed without notice. Valid from 2025.08.01. Only for PROTOTYPES

360ST DECK LAYOUT & CABIN CONCEPT

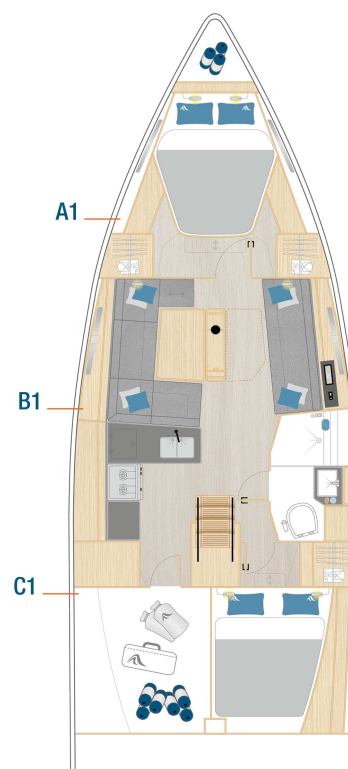
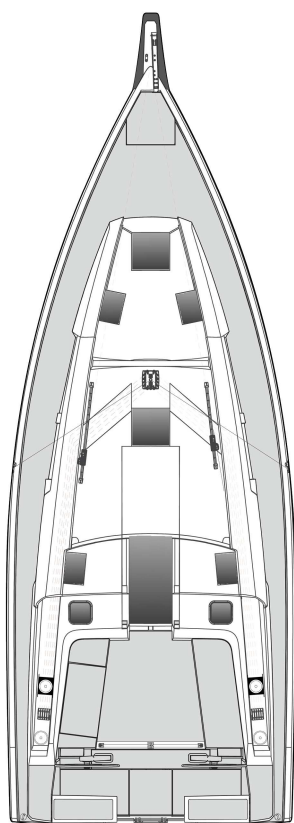

Standard

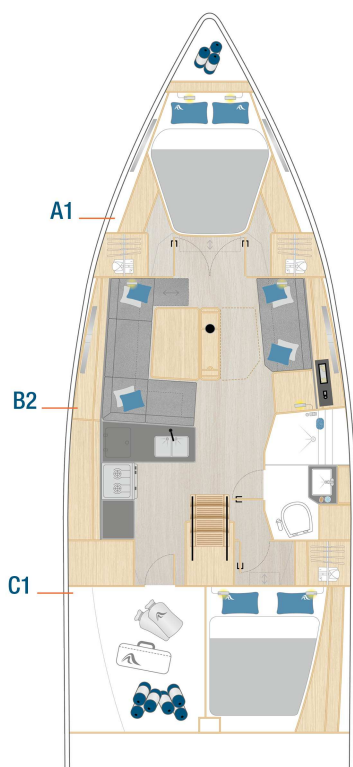

Option

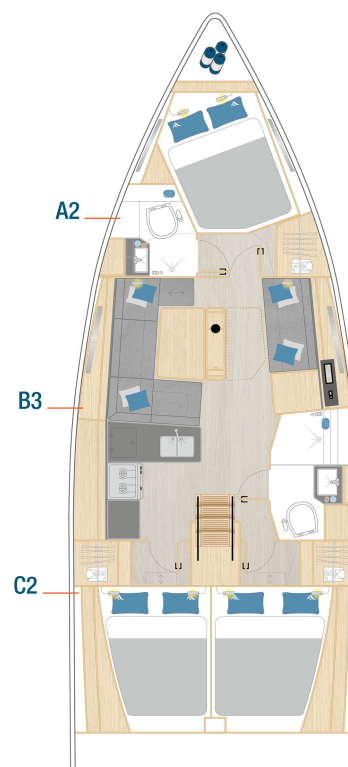

Option

HULL

- 6 hull windows (3 each side) similar like hull colour
- GRP hull, isophthalic gelcoat, colour: Signal White (similar RAL 9003), 1st layer vinyl ester resin and balsa sandwich laminat
- Waterline, isophthalic gelcoat, colour: Dark Grey (similar RAL 7043)

KEEL

- T-keel, cast iron, draft: 2.13 m
- ST-Line GRP rudder with stainless steel shaft and selfaligning bearings

LAYOUT & INTERIOR

- A1: Master cabin with island double berth and storage space
- B1: Saloon with large dining area on port and sofa on stb
- C1: Large L-galley and storage space on port. Head with separate shower stall, aft cabin with double berth, locker and storage on stb
- 2-burner gas stove with oven, waste bin, 12 V fridge approx. 135 l, double stainless steel sink with mixing tab
- Interior Design package ST-Line (black watertap, black reading lights, black down lights, black mast pole, black handrails). Interior furniture in high quality marine plywood, Satin Varnish
- Hanse companionway closing system
- Saloon table, fixed with integrated storage
- Worktop in galley and heads - Grey

WOOD (FURNITURE, FLOORBOARD)

- Furniture - Mahogany Style, Satin Varnish
- Cupboard fronts coloured (selected fronts as per design - colour selection)
- Floorboard - Acacia

UPHOLSTERY

- Mattresses for all berths
- Upholstery - Monte Carlo, colour: Cream
- ST-Line upholstery in saloon

DECK & OUTSIDE EQUIPMENT

- GRP deck with antislip surface, isophthalic gelcoat, colour: Signal White (similar RAL 9003), 1st layer vinyl ester resin with PET foam core. 1 cockpit locker, 1 space for life raft, stern locker, stowage for running rigging at helm position, anchor locker at bow.

- Twin wheel steering system with emergency tiller
- 2 GRP steering wheels, Y-spoke (black or white)
- ST-Line cockpit table, stainless steel with folding teak tops
- Pulpit and pushpit, stainless steel, colour: black
- Railing, incl. black stanchions and black covered dyneema rope
- Covered halyards and control lines lead to cockpit helmposition, organizers and jammers, 6 black mooring cleats, black handrails on coach roof
- 2 LEWMAR 45 ST RACE EVO manual halyard winches
- 2 LEWMAR 45 ST RACE EVO manual secondary winches
- Swimming ladder
- Helmsman footrests (free mountable)
- Anchor windlass, electrical, with automatic fuse and remote control with chain counter
- Delta-anchor 16 kg, galvanized with 30 m galvanized chain
- Composite bowsprit with integrated anchor and forestay fitting with mooring roll incl. Crossover and Gennaker tack point
- Genoa tracks incl. cars, adjustable from cockpit
- Self tacking jib system
- German mainsheet system with adjustable traveller
- 2 large and 6 small deck hatches - openable, anchor locker hatch
- 4 large coach roof side windows - openable, 3 portlights in coach roof

RIG & SAILS

- Rig (ST-Line), anodized aluminium with dyform rigging, deck stepped, with kicker, standing and running rigging and 2 reefs and ST-Line backstay, adjustable from both sides
- Manual jib furler
- ELVSTRØM SPS performance sails - full battened, triradial main and jib
- Dyneema halyards for main and jib
- Mainsail slider system

NAVIGATION & INSTRUMENTS

- Illuminated compass in cockpit
- Navigation lights - LED

PROPULSION

- Fuel tank, approx. 160 l
- Engine (Diesel, approx. 29 hp) - saildrive, 2-blade fix propeller
- Spinlock removable throttle

EQUIPMENT

- 12 V and 230 V electric system with main panels and 230 V shore power and sockets in cabins and heads
- AGM battery set, capacity: 1x 90 Ah + 2x 160 Ah AGM
- Country Version: EU / AUS
- Battery charger
- Manual toilet with sea water flush - cabin layout C
- Shower unit in cockpit, warm-/coldwater
- Water akku for pressure equalization
- LPG gas system, stowage for 1 gas bottle
- Black water system (appr. 54 l each bathroom) with deck extraction and seacock for head, electric and manual bilge pump
- Fresh water system with electric pump and 20 l hot water, heated also by main engine
- Fresh water tank, appr. 345 l

ACCESSORIES

- Wind indicator
- Flagpole
- 6 fenders
- 4 mooring lines
- Add. winch handle
- Mast steps
- Hanse maintenance kit

SHIPPING & TRANSPORT

- CE - Certificate cat. A - 6
- Owners manual
- EC - Type Examination Certificate

AS PER STANDARD SPECIFICATION

excl. VAT
225.900 €

PACKAGES

XW2000 Raymarine Navigation Package 6.400 €

- XF2200 2 Raymarine i70s multifunction displays in cockpit, incl. transducer (depth/speed/temperature) and RSW Wired Smart Wind transducer
- XF4010 Raymarine AXIOM2 PRO 9 S chart plotter with HybridTouch multifunction display at cockpit table

XW2002 Upgrade - Navigation Package 6.500 €

- XF3000 Raymarine VHF Ray73 in saloon, incl. wireless remote handset (only with XK5000)
- XF5000 Raymarine Evolution Autopilot with p70s display and wireless remote control
- XK5000 VHF preparation with antenna and splitter for FM and AIS

XW2003 Upgrade - Mast Display 4.250 €

- XF2240 Raymarine Alpha 9" multifunction display at mast

XW5000 Comfort Package 4.950 €

- XC9032 Courtesy lights in cockpit
- XC9033 Courtesy lights at companionway
- XC9040 Exterior Light Signature
- XC9300 Vent for coach roof hatch
- XL9003 Indirect lights in saloon and cabins
- XL9004 LED overhead lights in saloon and master cabin
- XN2500 Cockpit cushions (colour selection)
- XV9010 Blind set with flyscreens for deck hatches
- XV9060 Blinds for hull windows
- XV9080 Blinds for side coach roof windows

XW6500 Smart Connection Package 3.550 €

- XF4655 Interior camera
- XK5031 WLAN router incl. booster antenna

XW7000 Entertainment Package 2.200 €

XH2090	Wireless charging in saloon
XK1000	FUSION MS-RA70N Multimedia radio with bluetooth - for saloon and cockpit (only with XK5000)
XK2000	2x 2 speakers in saloon and cockpit
XK3070	FUSION MS-NRX remote control in cockpit

XW7001 Upgrade - Premium Radio 1.050 €

XK1001	FUSION APOLLO MS-RA770 Multimedia radio with Wi-Fi and touchscreen - for saloon and cockpit (only with XK5000)
XK3071	FUSION MS-ERX400 remote control in cockpit
XK5030	FUSION wireless link - remote control via mobile devices

XW7030 TV Package - Saloon 1.750 €

XK4040	TV preparation in saloon
XK4100	LED TV flat screen in saloon
XK5020	DVB-T2 antenna for TV

OPTIONS

excl. VAT

HULL

XA1001	GRP hull, gelcoat colour: Grey (similar RAL 7040)	3.850 €
XA3001	Waterline, coloured gelcoat (colour selection)	600 €

KEEL

XB9000	Keel and rudder - not mounted	800 €
--------	-------------------------------	-------

LAYOUT & INTERIOR

XL1002	A2: Master cabin with double berth, storage space and separate head	5.500 €
XL2002	B2: Saloon with large dining area on port and sofa with chart table on stb	1.150 €
XL2003	B3: Saloon with large dining area on port and sofa with multi function unit, navigation console and storage on stb	1.550 €
XL3002	C2: L-galley on port and head with separate shower stall on stb. 2 aft cabins with double berth, locker and storage.	2.800 €
XL6051	Double door in main bulkhead (only with A1 layout)	2.700 €
XL7001	Saloon table, foldable with integrated bar	1.450 €

XL7201	Seating area in saloon convertible into double berth (only with XL7001)	1.450 €
--------	---	---------

WOOD (FURNITURE, FLOORBOARD)

XM1102	Furniture - Teak	3.850 €
XM1103	Furniture - Canadian Chestnut	3.850 €
XM1104	Furniture - French Oak	3.850 €
XM1201	Floorboard - Classic Stripes	1.900 €
XM1202	Floorboard - Noce Nero	800 €
XM1203	Floorboard - Delight Oak	800 €

UPHOLSTERY

XN2001	Upholstery - Sorrento (colour selection)	800 €
XN2002	Upholstery - Florence (colour selection)	1.300 €
XN2003	Upholstery - Monaco (colour selection)	1.700 €
XN2004	Upholstery - Portofino Leather (colour selection)	3.500 €
XN2400	Sun bed cushions on coach roof (colour selection)	1.200 €
XN2500	Cockpit cushions (colour selection)	1.400 €
XN2503	Cushion for helmsman seats (colour selection - only with XC9060)	600 €

DECK & OUTSIDE EQUIPMENT

XC1101	Side decks and cockpit bottom, gelcoat colour: Grey (similar RAL 7040)	1.150 €
XC1300	Real teak on side deck	12.250 €
XC1301	Synthetic teak on side deck (colour selection)	11.850 €
XC1310	Real teak on coach roof	5.700 €
XC1311	Synthetic teak on coach roof (colour selection)	5.300 €
XC1325	Real teak on cockpit bottom	3.950 €
XC1326	Synthetic teak on cockpit bottom (colour selection)	3.250 €
XC1333	Real teak on helmsman seats (only with XC9060)	690 €
XC1334	Synthetic teak on helmsman seats (colour selection - only with XC9060)	900 €
XC1340	Real teak on cockpit benches	2.290 €
XC1341	Synthetic teak on cockpit benches (colour selection)	2.050 €
XC1350	Real teak on bathing platform (only with XC6001)	1.690 €
XC1351	Synthetic teak on bathing platform (colour selection - only with XC6001)	1.500 €
XC4001	Gateway stanchion	1.050 €
XC5102	2 LEWMAR 45 EST RACE EVO electrical halyard winches with automatic fuse	7.500 €

XC6001	Bathing platform, manual fold-out with swimming ladder	2.500 €
XC9020	Rub rail, teak	1.500 €
XC9060	2 helmsman seats, foldable	1.500 €
XC9101	Delta-anchor 16 kg, stainless steel, with 'Power Ball' swivel and 50 m stainless steel chain	3.850 €

RIG & SAILS

XE1231	Electric furler CXe25 for Crossover and Gennaker (only with XH1005)	5.900 €
XE2001	Lazy bag with lazy jacks (colour selection)	1.200 €
XE2012	ST-Line Sprayhood with stainless steel stake, 3 windows (1 openable - colour selection)	2.900 €
XE3010	ELVSTRØM HPM high - performance sails, full battened, UV protected membrane, main and jib	8.600 €
XE3021	ELVSTRØM SPS performance sail - 110% Genoa, short battened, triradial	3.900 €
XE3022	ELVSTRØM HPM high - performance sail - 110% Genoa, short battened, UV protected membrane	6.700 €
XE3100	ELVSTRØM Gennaker (colour selection)	4.300 €
XE3101	ELVSTRØM Top Down Gennaker (colour selection - only with XE1231)	5.600 €
XE3110	Squeezer for Gennaker (only with XE3100)	690 €
XE3300	ELVSTRØM CZ Crossover sail - with CX endless furler and storage bag	5.200 €
XE3301	ELVSTRØM CZ Crossover sail - prepared for electric furler with storage bag (only with XE1231)	4.500 €
XE9003	Gennaker package incl. halyard, 2 sheets, 2 blocks and padeye (not with XE9004)	1.100 €
XE9004	Crossover package incl. 2:1 halyard, 2 sheets, 2 blocks and padeye (not with XE9003)	1.300 €

NAVIGATION & INSTRUMENTS

XF4600	Raymarine AIS Class B transponder (only with chart plotter and XK5000)	1.650 €
--------	--	---------

PROPULSION

XG1001	Engine (Diesel, approx. 29 hp) - saildrive, 2-blade folding propeller	1.750 €
XG1101	Engine (Diesel, approx. 39 hp) - saildrive, 2-blade folding propeller	4.950 €
XG1500	Electric propulsion (approx. 25kW / 18,4kWh battery) - saildrive, 3-blade folding propeller	27.000 €
XG1510	Electric propulsion (approx. 25kW / 36,7kWh battery) - saildrive, 3-blade folding propeller	37.000 €
XG3101	Bowthruster, 12 V, retractable, incl. battery	9.550 €
XG3201	Sternthruster, 12 V, retractable, incl. battery (only with XG3101)	13.650 €

EQUIPMENT

XH1005	Battery set, capacity: 1x 90 Ah + 2x 200 Ah Lithium	7.350 €
XH1601	Country Version: US / JPN	1.800 €
XH2080	Solar panel on coach roof	5.800 €

XH2085	Fuel Cell Pro 2800 BT max. 125 W	10.400 €
XH2201	Inverter/charger, incl. larger AC panel	2.950 €
XH3001	Electric toilet with sea water flush - cabin layout C	1.450 €
XH3011	Electric toilet with sea water flush - cabin layout A2	1.450 €
XH4011	Heating, hot air with blowers in saloon, heads and master cabin	4.650 €
XH4021	Outlet for heating in aft cabin stb (only with XH4011 and layout C1)	500 €
XH4022	Outlet for heating in aft cabins (only with XH4011 and layout C2)	700 €
XH4511	Air conditioning, 12.000 BTU, 1 unit: saloon and master cabin, incl. 2nd shore power	11.750 €
XH4514	Air conditioning, 8.000 BTU, 1 unit: aft cabin (only with XH4511)	7.350 €
XH5100	Additional drawer fridge/freezer combination in multifunction unit (only with layout B3)	2.300 €
XH5101	Additional drawer fridge/freezer combination in galley (only with layout C1)	2.300 €
XH5150	Microwave in galley	1.600 €
XH5409	Gas leak detector	1.050 €
XH5610	Grey water system "Lakes" for bathrooms and galley, tank: 79 l - no hull-through fittings for grey and black water	2.650 €
XH6001	Grey water system for bathrooms and galley, tank: 79 l	2.850 €

RADIO & ENTERTAINMENT

XK5000	VHF preparation with antenna and splitter for FM and AIS	750 €
--------	--	-------

ACCESSORIES

XV9120	Cover for cockpit table (colour selection)	550 €
XV9130	Cover for steering wheels (colour selection)	550 €

SHIPPING & TRANSPORT

XZ2001	Loading on truck	600 €
XZ2003	Oversea shipping pack (cradle)	3.550 €
XZ2020	Ready for Pickup	700 €

All mentioned prices in €, basic prices ex yard and excl. VAT. All weights and measures are calculated numbers based on the construction data. Changes in construction and equipment reserved.
 Above mentioned prices are recommended for ex yard deliveries within 4 month after order confirmation. For later delivery time the company reserves right to apply latest price list. Company reserves additional 15 working days when painted hull or deck is ordered. All measurements/figures are approximate. Errors and omissions excepted. Specification and material can be changed without notice.
 Valid from 2025.08.01. Only for PROTOTYPES