

PRICELIST & SPECIFICATION



588

LOA		17.20 m	56' 5"
Hull length		16.70 m	54' 9"
LWL		15.15 m	49' 8"
Beam		5.20 m	17' 1"
Draft			
shallow keel		2.25 m	7' 5"
L-keel, medium		2.60 m	8' 6"
T-keel, deep		2.85 m	9' 4"
Displacement			
shallow keel	approx.	23.00 t	50,706 lbs
L-keel, medium	approx.	22.80 t	50,265 lbs
T-keel, deep	approx.	22.20 t	48,943 lbs
Engine Diesel			
standard	approx.	110 PS	110 hp
option	approx.	150 PS	150 hp
Fuel tank	approx.	520 l	137 gal
Fresh water	approx.	770 l	203 gal
CE Certificate	A - 12		
Design	judel / vrolijk & co		
Interior	HanseYachts Design		

Mast length above WL	approx.	25.85 m	84' 10"
Total sail area	approx.	156.80 m ²	1,688 sq ft
Main sail			
standard	approx.	92.80 m ²	999 sq ft
furling	approx.	80.40 m ²	865 sq ft
Self-tacking jib	approx.	64.00 m ²	689 sq ft
Reacher	approx.	110.90 m ²	1,194 sq ft
Gennaker	approx.	246.50 m ²	2,653 sq ft

All measurements/figures are approximate. Errors and omissions excepted. Specification and material can be changed without notice. Valid from 2023.01.01 for deliveries until 2024.06.30.

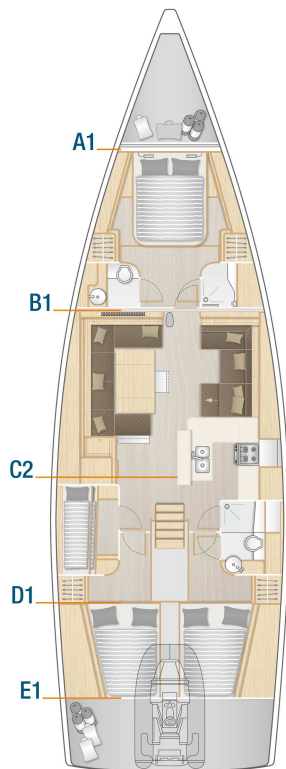
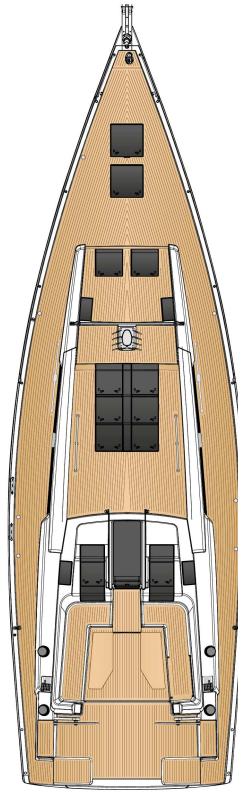

Standard

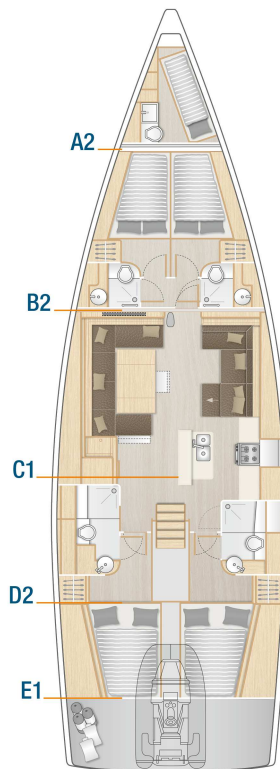

Option

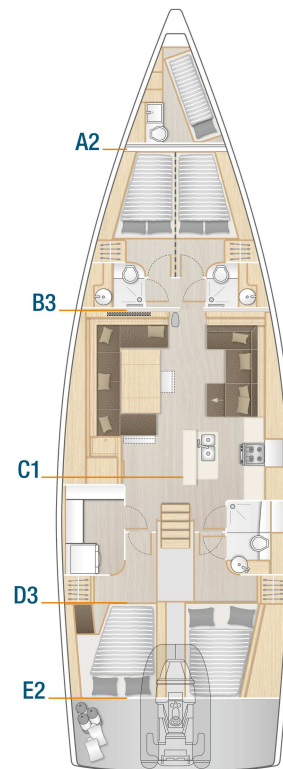

Option

HULL

- 12 hull windows (6 each side)
- GRP hull, isophthalic gelcoat, colour: Signal White (RAL9003), 1st layer vinyl ester resin and balsa sandwich laminat
- Waterline and cove line, isophthalic gelcoat, colour: Dark Grey (RAL 7043)

KEEL

- L-keel, cast iron, draft: 2.60 m
- GRP rudder with sea-water resistant aluminium shaft and selfaligning bearings

LAYOUT & INTERIOR

- A1: Sail locker with extensive storage space
- B1: Master cabin with island double berth, storage space and a head with separate shower stall
- C2: Saloon with full functional L-galley and dining area on stb and lounge area with chart table on port
- D1: Cabin with double bunk bed on port with storage space and dayhead door for head in saloon on stb.
- E1: 2 aft cabins with double berth, storage space and separate head
- 3-burner gas stove with oven, ventilation hood, waste bin, 12 V fridge approx. 140 l, double stainless steel sink with mixing tab
- Interior furniture in high quality marine plywood, Satin Varnish
- Hanse companionway closing system
- Saloon table, fixed
- Silent Master Cabin - cabin noise insulation (only with B1 Layout)
- Worktop in galley - 'Marine Mineral Stone' Anthracite

WOOD (FURNITURE, FLOORBOARD)

- Furniture - Mahogany Style, Satin Varnish
- Floorboard - Acacia

UPHOLSTERY

- Mattresses for all berths
- Upholstery - Monte Carlo, colour: Cream

DECK & OUTSIDE EQUIPMENT

- GRP deck with antislip surface, isophthalic gelcoat, colour: Signal White (RAL 9003), 1st layer vinyl ester resin with balsa sandwich core. Cockpit locker on stb, dinghy garage, stowage for running rigging at helm position, anchor locker at bow.
- Teak on cockpit bottom
- Teak on cockpit benches
- Teak on bathing platform
- Twin wheel steering system
- 2 stainless steel steering wheels with leather cover
- 2 cockpit tables, stainless steel with teak tops
- Pulpit and pushpit, stainless steel
- Railing, incl. stanchions and stainless steel wire with gateway stanchion
- Covered halyards and control lines lead to cockpit helmposition, organizers and jammers, 6 retractable mooring cleats, handrails on coach roof
- 2 LEWMAR 65 ST EVO manual halyard winches
- 2 LEWMAR 55 ST EVO manual secondary winches
- Bathing platform, hydraulic fold-out, remote control and swimming ladder
- Anchor windlass, electrical, 1500 W, with automatic fuse and remote control with chain counter
- Anchor and forestay fitting
- Self tacking jib system
- Mainsheet system
- 12 big and 4 small deck hatches - openable, anchor locker hatch, stowage on coach roof with acrylic glass hatch
- 6 deck coach roof windows - 4 openable, glass next to companionway, portlights in cockpit side for aft-cabins

RIG & SAILS

- Rig, anodized aluminium, keel stepped, with kicker, standing and running rigging and 2 reefs
- Manual jib furler
- QUANTUM Dacron sails - full battened, main and jib

NAVIGATION & INSTRUMENTS

- Illuminated compass at each helm
- Navigation lights - LED

PROPULSION

- Fuel tank, approx. 520 l
- Engine (Diesel, approx. 110 hp) - shaft drive, 3-blade folding propeller

EQUIPMENT

- 12 V and 230 V electric system with main panels and 230 V shore power and sockets in cabins and heads
- AGM battery set, capacity: 1x 90 Ah + 2x 160 Ah AGM
- Country Version: EU / AUS
- Battery charger 70 A
- Manual toilet with sea water flush - cabin layout B1
- Manual toilet with sea water flush - cabin layout E1 or E2
- Shower unit in cockpit, warm-/coldwater
- LPG gas system, stowage for 2 gas bottles
- Black water system (appr. 35 l per fwd head, appr. 85 l per aft head) with deck extraction and seacock for head, electric and manual bilge pump
- Fresh water system with electric pump and 40 l hotwater, heated also by main engine
- Fresh water tank, appr. 770 l

ACCESSORIES

- Mast steps

SHIPPING & TRANSPORT

- CE - Certificate cat. A - 12 / B - 16 / C - 20
- Owners manual
- EC - Type Examination Certificate

AS PER STANDARD SPECIFICATION

excl. VAT
624.900 €

PACKAGES

XW2000 B&G Navigation Package 19.090 €

XF2000	2 instrument pods (1 per helm station)
XF2200	2 B&G Triton ² multifunction displays in cockpit, incl. transducer (wind/depth/speed/temperature)
XF2213	2 B&G Triton ² multifunction displays, 1 per helm station
XF3000	B&G VHF V60 at chart table, incl. wireless remote handset H60
XF4030	2 B&G Zeus ³ S 9" chart plotter, 1 per helm station
XF5000	B&G Autopilot with Triton ² control unit with WR10 remote control and Precision 9 compass
XK5000	VHF preparation with antenna and splitter for FM and AIS

XW2001 Upgrade - H5000 instruments 6.690 €

XF2201	2 B&G H5000 multifunction displays in cockpit, incl. transducer (wind/depth/speed/temperature)
XF2214	2 B&G H5000 multifunction displays, 1 per helm station (only with XF2000)
XF4600	B&G AIS Class B transponder (only with chart plotter and XK5000)
XF5001	B&G Autopilot with H5000 control unit with WR10 remote control and Precision 9 compass
XF5200	B&G CPU Hydra computer (only with XF2201)
XF9100	GoFree wireless link

XW2002 Upgrade - 12" chart plotter 4.790 €

XF4031	2 B&G Zeus ³ S 12" chart plotter, 1 per helm station
XF9001	NMEA Engine information interface for chart plotter (only with chart plotter)

XW3100 Cruising Package 24.990 €

XC9062	Helmsman footrests (free mountable)
XC9080	4 additional cleats, midship, retractable (2 each side)
XC9100	Delta-anchor 40 kg, galvanized with 60 m galvanized chain
XE1102	Backstay tensioner, hydraulic
XG3101	Bowthruster, 24 V, retractable, incl. battery
XH1001	Battery set, capacity: 1x 90 Ah + 4x 160 Ah AGM
XH2201	Inverter/charger, 12 V / 2600 W - 100 A, incl. AC panel (only with XH1001)
XH5030	Water akku for pressure equalization

XV9420	Wind indicator
XV9450	Flagpole
XV9901	8 fenders
XV9902	4 mooring lines
XV9910	Add. winch handle
XV9950	HANSE maintenance kit

XW3101	Upgrade - Flexiteek (colour selection)	1.190 €
---------------	---	----------------

XC1321	Flexiteek on cockpit bottom
XC1341	Flexiteek on cockpit benches
XC1351	Flexiteek on bathing platform

XW3102	Upgrade - Stainless steel anchor with chain	4.790 €
---------------	--	----------------

XC9101	Delta-anchor 40 kg, stainless steel, with 'Power Ball' swivel and 100 m stainless steel chain
--------	---

XW4000	Performance Package	11.490 €
---------------	----------------------------	-----------------

XC2201	2 GRP steering wheels, Y-spoke (black or white)
XE3005	QUANTUM AC5 performance sails - full battened, triradial, main and jib
XE9001	Dyneema halyards for main and jib
XE9002	Selden MDS mainsail slider system

XW4002	Upgrade - Performance keel	3.490 €
---------------	-----------------------------------	----------------

XB1002	T-keel, cast iron, draft: 2.85 m
--------	----------------------------------

XW4100	Gennaker Package	10.190 €
---------------	-------------------------	-----------------

XE3105	QUANTUM Gennaker (colour selection - only with XC9161)
XE3110	Squeezer for Gennaker
XE9003	Gennaker package incl. halyard, 2 sheets, 2 blocks and padeyes (only with XC9161)

XW4500	Carbon Mast Package	157.490 €
---------------	----------------------------	------------------

XE1002	Mast, carbon, with rod rigging (not with XE2051 or XE2052 or XE2053)
XE1060	Boom, black, anodized aluminium
XE3010	QUANTUM TP6 high - performance sails, full battened, UV protected membrane, main and jib
XE9100	Spreader lights, LED, 6 up and 6 down

XW4501 Upgrade - Carbon V-Boom 76.590 €

XE1070 V-Boom, carbon

XW4502 Upgrade - Carbon Furling V-Boom 157.490 €

XE1071 Furling V-Boom, carbon incl. furl finder

XW5000 Comfort Package 11.490 €

XC9032 Courtesy lights in cockpit

XC9051 Electrical deck wash pump, mounted in bow area with outlet on deck

XC9300 2 vents for coach roof hatches

XL9001 Courtesy lights in saloon

XL9003 Indirect lights in saloon and cabins

XL9004 LED overhead lights in saloon and cabins, dimmable

XL9010 SLS - Scenario light system - touch screen controller and dimmer in saloon and fwd cabin

XN2500 Cockpit cushions (colour selection)

XV9010 Blind set with flyscreens for deck hatches

XV9060 Blinds for hull windows

XV9080 Blinds for side coach roof windows

XW6500 Smart Connection Package 2.990 €

XF4655 Interior camera

XK5031 WLAN router incl. booster antenna

XW7000 Entertainment Package - Saloon and Cockpit 3.590 €

XH2090 Wireless charging

XK1000 FUSION APOLLO MS-RA770 Multimedia radio with Wi-Fi and touchscreen - for saloon and cockpit (only with XK5000)

XK1200 Subwoofer with integrated amplifier in saloon

XK2040 4 high-end 2-way speakers in saloon

XK2070 2 high-end 2-way speakers in cockpit

XK3000 FUSION MS-ERX400 remote control in cockpit

XK5030 FUSION wireless link - remote control via mobile devices

XW7010 Entertainment Package - Owner`s cabin 4.590 €

XK1010	FUSION APOLLO MS-RA770 Multimedia radio with Wi-Fi and touchscreen - for master cabin (only with XK5000)
XK2010	2 high-end 2-way speakers in master cabin
XK4010	TV preparation in master cabin (only with XL2001)
XK4110	LED TV flat screen in master cabin (only with XL2001)

XW7030 TV Package - Saloon 4.490 €

XK4040	TV preparation in saloon
XK4140	LED TV flat screen in saloon
XK4240	TV lifting system in saloon

OPTIONS

excl. VAT

HULL

XA1001	GRP hull, gelcoat colour: Grey (RAL 7040)	6.390 €
XA1002	GRP hull, painted, non metallic (colour selection)	30.390 €
XA1003	GRP hull, painted, metallic (colour selection)	39.890 €
XA3001	Waterline and cove line, coloured gelcoat (colour selection - not with XA1002 or XA1003)	890 €
XA3002	Waterline and cove line, painted, non metallic (colour selection - only with XA1002 or XA1003)	1.090 €
XA3003	Waterline and cove line, painted, metallic (colour selection - only with XA1002 or XA1003)	1.290 €

KEEL

XB1001	L-keel, cast iron, draft: 2.25 m	5.090 €
XB1002	T-keel, cast iron, draft: 2.85 m	5.790 €
XB9000	Keel and rudder - not mounted	1.090 €

LAYOUT & INTERIOR

XL1002	A2: Crew cabin with sink, toilet and storage space	7.690 €
XL2002	B2: 2 fwd cabins with double berth, storage space and separate head with shower	5.490 €
XL2003	B3: 2 fwd cabins with double berth, storage space and separate head with shower - convertible by a removable bulkhead into a single cabin	7.090 €
XL3001	C1: Saloon with full functional island galley and dining area on stb and lounge area with chart table on port	3.390 €
XL4002	D2: Head on port with sink, toilet and separate shower stall	3.290 €
XL4003	D3: Utility room on port and dayhead door for head in saloon on stb	4.290 €

XL5002	E2: 2 aft cabins with VIP cabin on port incl. "Queen size" bed and guest cabin with separate head and double berth on stb, with storage space	4.090 €
XL6050	Day head door for head in saloon (only with XL4002)	1.090 €
XL7001	Saloon table electrically lowerable with cushions, convertible into double berth	2.790 €
XL7601	Worktop in galley - 'Marine Mineral Stone' Vanilla	890 €

WOOD (FURNITURE, FLOORBOARD)

XM1102	Furniture - Teak	8.090 €
XM1103	Furniture - Canadian Chestnut	8.090 €
XM1104	Furniture - French Oak	8.090 €
XM1150	Furniture - High Gloss Finish (only with XM1100 or XM1103)	19.490 €
XM1201	Floorboard - Classic Stripes	2.290 €
XM1202	Floorboard - Noce Nero	1.490 €
XM1203	Floorboard - Delight Oak	1.490 €
XM9000	Floorboard - wooden grating in all heads and showers	1.790 €

UPHOLSTERY

XN1100	Comfort mattresses for all berths (excluded A2 layout)	3.490 €
XN2001	Upholstery - Sorrento (colour selection)	1.690 €
XN2002	Upholstery - Florence (colour selection)	2.190 €
XN2003	Upholstery - Monaco (colour selection)	4.390 €
XN2004	Upholstery - Portofino Leather (colour selection)	7.640 €
XN2050	Comfort upholstery for saloon	1.890 €
XN2200	Sun bed cushions on foredeck (colour selection)	2.190 €
XN2400	Sun bed cushions on coach roof (colour selection)	2.290 €
XN2500	Cockpit cushions (colour selection)	2.790 €
XN2503	Cushion with backrest for helmsman seats (colour selection - only with XC9060)	1.190 €
XN2505	Cushion for wetbar (colour selection)	490 €

DECK & OUTSIDE EQUIPMENT

XC1300	Teak on side deck	25.390 €
XC1301	Flexiteek on side deck (colour selection)	25.790 €
XC1310	Teak on coach roof	8.090 €
XC1311	Flexiteek on coach roof (colour selection)	8.590 €
XC1333	Teak on helmsman seats (only with XC9060)	990 €

XC1334	Flexiteek on helmsman seats (colour selection - only with XC9060)	1.090 €
XC2201	2 GRP steering wheels, Y-spoke (black or white)	1.890 €
XC3004	2 cockpit tables, aluminium foot with teak tops, electrically lowerable into sunbed incl. upholstery	4.490 €
XC3100	Wetbar with BBQ and sink with mixing tab	5.690 €
XC5102	2 LEWMAR 65 EST EVO electrical halyard winches with automatic fuse (only with XH1001)	9.490 €
XC5202	2 LEWMAR 55 EST EVO electrical secondary winches with automatic fuse (only with XH1001)	12.890 €
XC6501	Gangway, carbon, foldable with bag, 220 cm	2.990 €
XC6502	Gangway, retractable, electric/hydraulic with remote control	27.590 €
XC6601	Stainless steel ladder for gateway exit, foldable	1.090 €
XC7001	Easy Tender System (windlass and launching system)	8.990 €
XC7100	Air compressor for tender	890 €
XC9020	Rub rail, teak	2.690 €
XC9021	Additional stainless steel rail (only with XC9020)	2.590 €
XC9036	LED lights for side decks, integrated in toerail, white	3.490 €
XC9041	4 underwater multicolour lights (red, green, blue and white) below transom	4.590 €
XC9051	Electrical deck wash pump, mounted in bow area with outlet on deck	1.190 €
XC9060	2 helmsman seats, foldable (only with XC1333 or XC1334)	2.690 €
XC9161	Anchor and forestay fitting with double mooring roll incl. 2nd forestay and gennaker eye	1.490 €
XC9200	Genoa tracks incl. cars with pin stop	1.590 €

RIG & SAILS

XE1001	Mast, anodized aluminium with manual inmast furling system (only with XE3001, XE3005 or XE3010)	4.590 €
XE1010	Mast, anodized aluminium with electric inmast furling system (only with XH1001 and XE3001, XE3005 or XE3010)	15.590 €
XE1210	Electric jib furler (only with XH1001)	11.490 €
XE1221	Second forestay with second furler, electrical (only with XH1001 and XC9161)	14.690 €
XE2001	Lazy bag with lazy jacks (colour selection - not with XE1001, XE1010 and XE1071)	1.690 €
XE2009	Canvas windscreen with stainless steel stake (not with XE2012)	3.890 €
XE2010	Fixed windscreen with stainless steel frame (not with XE2012)	7.390 €
XE2012	Sprayhood with stainless steel stake, 3 windows (1 openable - colour selection - not with XE2009 or XE2010 or XE2051 or XE2052 or XE2053)	4.090 €
XE2013	Cockpit canvas cover for GRP hardtop - side and front (colour selection - only with XE2051 or XE2052 or XE2053 and XE2009 or XE2010)	3.490 €
XE2021	Bimini with stainless steel stake (colour selection - not with XE2051, XE2052 and XE2053)	5.190 €
XE2051	GRP hard top for cockpit with canvas sliding roof - outside surface, colour: White	29.390 €
XE2052	GRP hard top for cockpit with canvas sliding roof - outside surface painted, non metallic (colour selection)	34.290 €

XE2053	GRP hard top for cockpit with canvas sliding roof - outside surface painted, metallic (colour selection)	36.790 €
XE2060	T-Top not mounted	1.090 €
XE3001	QUANTUM Blue Water Dacron sails - full battened, main and jib (with XE1001 and XE1010 no battens)	3.490 €
XE3005	QUANTUM AC5 performance sails - full battened, triradial, main and jib	9.190 €
XE3010	QUANTUM TP6 high - performance sails, full battened, UV protected membrane, main and jib	18.490 €
XE3023	QUANTUM AC5 performance sail - for second forestay, triradial, Reacher (only with XE1221 and XC9200 and XC9161)	13.790 €
XE3025	QUANTUM TP6 high - performance sail - for second forestay, UV protected membrane, Reacher (only with XE1221 and XC9200 and XC9161)	19.590 €
XE9001	Dyneema halyards for main and jib	1.490 €
XE9100	Spreader lights, LED, 6 up and 6 down	3.990 €

NAVIGATION & INSTRUMENTS

XF3000	B&G VHF V60 at chart table, incl. wireless remote handset H60	1.190 €
XF4000	B&G Zeus ³ S 12" chart plotter at chart table	4.490 €
XF4500	B&G HAL020+ Broadband Radar (only with chart plotter)	3.890 €
XF4560	MyHanse Safety Cloud hardware with 30 days free trial subscription and an interior light, switchable by APP	1.490 €
XF4600	B&G AIS Class B transponder (only with chart plotter and XK5000)	1.590 €
XF4650	Thermal vision camera at mast (only with Navigation Package)	6.390 €
XF4653	SEA.AI Offshore ONE (only with Navigation Package)	11.590 €
XF4701	B&G Forward looking sonar (only with chart plotter)	1.690 €

PROPULSION

XG1007	Engine (Diesel, approx. 150 hp) - shaft drive, 4-blade folding propeller	9.190 €
XG3101	Bowthruster, 24 V, retractable, incl. battery	14.890 €
XG3201	Sternthruster, 24 V, retractable, incl. battery (only with XG3101)	16.440 €
XG3211	Add. electronic throttle control at helm position, on port	3.390 €

EQUIPMENT

XH1110	Deep charge protection for service batteries	1.390 €
XH1601	Country Version: US / JPN	3.490 €
XH2101	Generator 8000i, 6,4 kW / 0 - 7,2 kVA, incl. maintenance kit	19.490 €
XH2102	Generator 10000i, 8,0 kW / 0 - 9,0 kVA, incl. maintenance kit	23.090 €
XH2201	Inverter/charger, 12 V / 2600 W - 100 A, incl. AC panel (only with XH1001)	3.490 €
XH3011	Electric toilet with sea water flush - cabin layout B1	1.690 €

XH3013	2 electric toilets with sea water flush - cabin layout B2 or B3	3.390 €
XH3021	Electric toilet with sea water flush - cabin layout E1 or E2	1.690 €
XH3031	Electric toilet with sea water flush - cabin layout D2	1.690 €
XH3200	Freshwater dockside connection in cockpit	690 €
XH4100	Heating, hot water ring with blowers in each cabin and head	13.990 €
XH4511	Air conditioning, 40.000 BTU, 4 units: 2 saloon, fwd cabin, aft cabin, incl. 2nd shore power	23.240 €
XH5020	Water maker, 230 V, 200 l / h (only with XH2102)	24.090 €
XH5100	Additional fridge in saloon (not with XH5101 and XH5112 - only with XH1001)	2.190 €
XH5101	Additional freezer in saloon (not with XH5100 and XH5112 - only with XH1001)	2.190 €
XH5110	Additional fridge in wetbar (only with XC3100)	2.190 €
XH5112	Wine cooler in saloon (not with XH5100 and XH5101 - only with XH1001)	2.690 €
XH5120	Additional freezer in utility room (only with XL4003 and XH1001)	2.190 €
XH5125	Optional freezer drawer in standard fridge	490 €
XH5150	Microwave in galley	1.790 €
XH5160	Coffee machine in galley	890 €
XH5210	Dishwasher in galley	3.490 €
XH5311	Washing machine with dryer function, front opening, in utility room - cabin layout D3	3.490 €
XH5409	Gas leak detector	990 €
XH6001	Grey water system for bathrooms and galley, tank: 100 l	3.390 €

RADIO & ENTERTAINMENT

XK5000	VHF preparation with antenna and splitter for FM and AIS	490 €
--------	--	-------

ACCESSORIES

XV9120	Cockpit table cover (colour selection)	990 €
XV9130	Cover for steering wheels (colour selection)	690 €
XV9380	Shrink wrap foil (for storage purpose only / not for transport) (not with XA1002, XA1003, XE2051, XE2052, XE2053, XE2010)	990 €

SHIPPING & TRANSPORT

XZ2001	Loading on truck	890 €
XZ2003	Oversea shipping pack (cradle)	4.490 €
XZ2020	Ready for pickup	690 €

All mentioned prices in €, basic prices ex yard and excl. VAT. All weights and measures are calculated numbers based on the construction data. Changes in construction and equipment reserved. Above mentioned prices are recommended for ex yard deliveries within 4 month after order confirmation. For later delivery time the company reserves right to apply latest price list. Company reserves additional 15 working days when painted hull or deck is ordered. All measurements/figures are approximate. Errors and omissions excepted. Specification and material can be changed without notice. Valid from 2023.01.01 for deliveries until 2024.06.30.