

SPECIFICATION

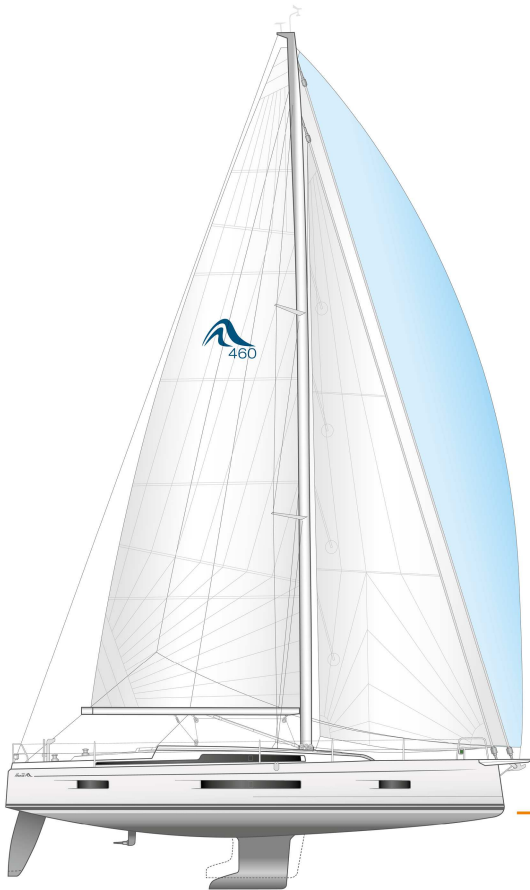

LOA		14.60 m	47' 11"
Hull length		13.87 m	45' 6"
LWL		13.05 m	42' 10"
Beam		4.79 m	15' 9"
Draft			
shallow keel		1.75 m	5' 9"
L-keel, medium		2.25 m	7' 5"
Displacement			
L-keel, medium	approx.	12.60 t	27,778 lbs
Engine Diesel			
standard	approx.	57 PS	57 hp
option	approx.	80 PS	80 hp
Fuel tank	approx.	210 l	55 gal
Fresh water	approx.	450 l	119 gal
CE Certificate	A - 12		
Design	Berret - Racoupeau		
Interior	Berret - Racoupeau		

Mast length above WL	approx.	21.90 m	71' 10"
Upwind sail area	approx.	114.00 m ²	1,227 sq ft
Downwind sail area	approx.	234.00 m ²	2,519 sq ft
Main sail	approx.	64.00 m ²	689 sq ft
Jib	approx.	42.00 m ²	452 sq ft
Genoa	approx.	50.00 m ²	538 sq ft
Reacher	approx.	78.00 m ²	840 sq ft
Gennaker	approx.	170.00 m ²	1,830 sq ft

460

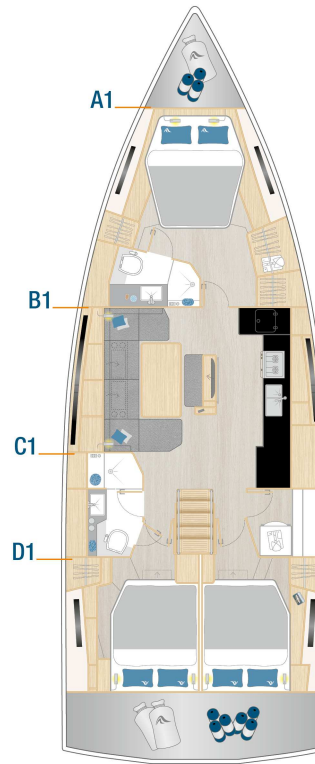
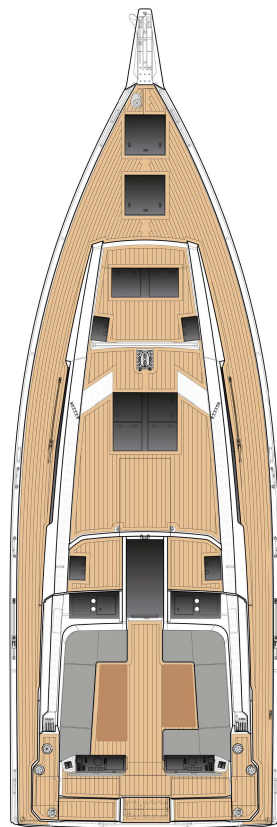

Standard

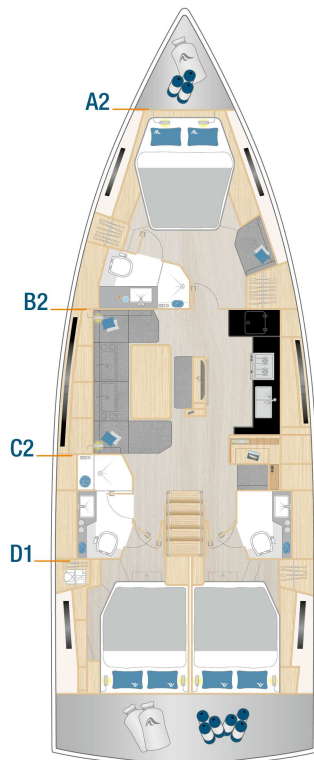

Option

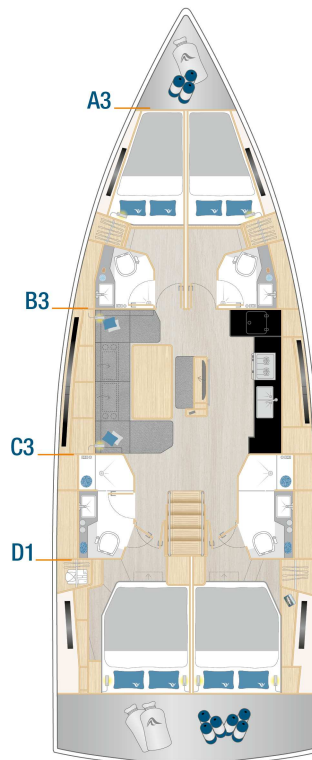

Option

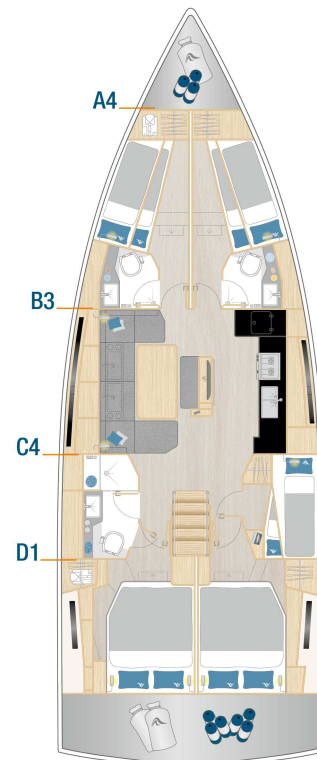

Option

HULL

- 8 hull windows (4 each side)
- GRP hull, isophthalic gelcoat, colour: Signal White (RAL 9003), 1st layer vinyl ester resin and balsa sandwich laminat
- Waterline and cove line, isophthalic gelcoat, colour: Dark Grey (RAL 7043)

KEEL

- L-keel, cast iron, draft: 2.25 m
- GRP rudder with sea-water resistant aluminium shaft and selfaligning bearings

LAYOUT & INTERIOR

- A1: Master cabin with island double berth, 1 locker and 1 big locker and ensuite head with separate shower stall
- B1: Saloon with full functional large L-galley on stb and dining area with bar on port (only with C1 or C2 layout)
- C1: Head with separate shower stall and dayhead door on port and utility room on stb (not with B3 layout)
- D1: 2 aft cabins with VIP cabin on port incl. "Queen size" bed and guest cabin on stb with double berth and storage space
- 3-burner gas stove with oven, waste bin, 12 V fridge approx. 135 l, double stainless steel sink with mixing tap
- Interior furniture in high quality marine plywood, Satin Varnish
- Hanse companionway closing system
- Saloon table, fixed
- Worktop in galley and heads - Black Quartz

WOOD (FURNITURE, FLOORBOARD)

- Furniture - Mahogany Style, Satin Varnish
- Galley cupboard fronts in wood colour
- Floorboard - Acacia

UPHOLSTERY

- Mattresses for all berths
- Upholstery - Monte Carlo, colour: Cream

DECK & OUTSIDE EQUIPMENT

- GRP deck with antislip surface, isophthalic gelcoat, colour: Signal White (RAL 9003), 1st layer vinyl ester resin with balsa sandwich core. 2 cockpit lockers, 1 space for life raft, stern locker on port, stowage for running rigging at helm position, anchor locker at bow.

- Twin wheel steering system with emergency tiller
- 2 stainless steel steering wheels with leather cover
- Cockpit table, stainless steel with teak tops, on stb
- Cockpit table, stainless steel with teak tops, on ps
- Pulpit and pushpit, stainless steel
- Railing, incl. stanchions and stainless steel wire
- Covered halyards and control lines lead to cockpit helmposition, organizers and jammers, 4 mooring cleats, handrails on coach roof
- 2 LEWMAR 45 ST EVO manual halyard winches
- Bathing platform, manual fold-out with swimming ladder
- Composite bowsprit with integrated anchor and forestay fitting
- Self tacking jib system
- Mainsheet system
- 8 large and 6 small deck hatches - openable, anchor locker hatch
- 4 large coach roof side windows - openable, 4 portlights in coach roof

RIG & SAILS

- Rig, anodized aluminium, deck stepped, with kicker, standing and running rigging and 2 reefs
- Backstay tensioner, manual
- Manual jib furler
- QUANTUM Dacron sails - full battened, main and jib

NAVIGATION & INSTRUMENTS

- Illuminated compass at each helm
- Navigation lights - LED

PROPULSION

- Fuel tank, approx. 210 l
- Engine (Diesel, approx. 57 hp) - saildrive, 3-blade fix propeller
- Throttle control at helm position, stb

EQUIPMENT

- 12 V and 230 V electric system with main panels and 230 V shore power and sockets in cabins and heads
- AGM battery set, capacity: 1x 90 Ah + 1x 160 Ah AGM
- Country Version: EU / AUS
- Battery charger 35 A
- Manual toilet with sea water flush - cabin layout A1 or A2

- Manual toilet with sea water flush - cabin layout C1 or C4
- LPG gas system, stowage for 1 gas bottle
- Black water system (appr. 85 l each bathroom) with deck extraction and seacock for head, electric and manual bilge pump
- Fresh water system with electric pump and 40 l hot water, heated also by main engine
- Fresh water tank, appr. 450 l

SHIPPING & TRANSPORT

- CE - Certificate cat. A - 12, B - 14, C - 16
- Owners manual
- EC - Type Examination Certificate