

HANSE

588



Hanse 588 - CHARTER EDITION

regular price 661.360 EUR

543.884 EUR*

FULLY EQUIPPED FOR CHARTER

SAVING: 117.476 EUR

Estimated yearly charter management profit: 64.942 €

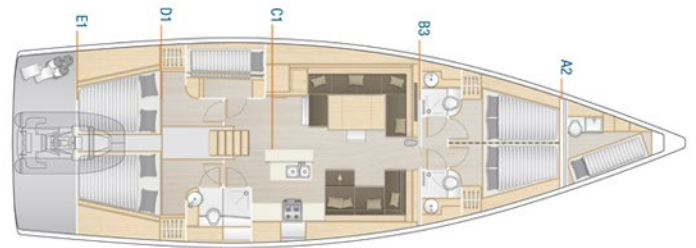

VALID TILL 30.10.2020.

- * The prices do not include VAT
- * The above indicated prices are valid only if the charter management contract is signed (minimum two years period)
- * Only valid for next available slot
- * Boat has to be taken over and paid in full after completion of the boat (if boat is not paid in time, discount will be recharged)

See full yacht specification below

CROATIA YACHTING D.O.O.

Split | tel: +385 (21) 332 332 | sales@hanseyachts.hr

Hanse
BREAKING RULES . SETTING TRENDS

www.hanseyachts.hr

| | | | | | | | | | | |
|------------------------|------------------|--|---|----------|----------|---|------|---------------------|---------------------|---------------------|
| XZ2001 | Loading on truck | | X | 650,00 € | 650,00 € | 1 | 100% | 0,00 € | 0,00 € | |
| LIST PRICE: | | | | | | | | 618.530,00 € | 618.530,00 € | |
| TOTAL DISCOUNT: | | | | | | | | 18,93% | 117.065,60 € | 117.065,60 € |
| TOTAL PRICE: | | | | | | | | 501.464,40 € | 501.464,40 € | |

| Additional components: | | Price ex VAT | | | | | | | |
|--|-------------|--------------|---|--------|-------------|-------------|--|---------------------|---------------------|
| Transport Greifswald - Umag | 11.750,00 € | 11.750,00 € | 1 | 0,00% | 11.750,00 € | 11.750,00 € | | | |
| Rigging (mast assembly and installation, installation of sails and rails) | 1.680,00 € | 1.680,00 € | 1 | 10,00% | 1.512,00 € | 1.512,00 € | | | |
| Antifouling (including materials - 2 layers of primer and antifouling) | 1.820,00 € | 1.820,00 € | 1 | 10,00% | 1.638,00 € | 1.638,00 € | | | |
| Costs of launching (including travel lift, 5 days land berth charges, 1 day sea berth charges) | 2.360,00 € | 2.360,00 € | 1 | 0,00% | 2.360,00 € | 2.360,00 € | | | |
| Final commissioning - test of equipment, Engine pre-delivery inspection, calibration of nav. instruments, cleaning | 600,00 € | 600,00 € | 1 | 10,00% | 540,00 € | 540,00 € | | | |
| Keel and rudder installation | 1.050,00 € | 1.050,00 € | 1 | 0,00% | 1.050,00 € | 1.050,00 € | | | |
| Bimini top, stainless steel frame - DARK GREY | 2.750,00 € | 2.750,00 € | 1 | 0,00% | 2.750,00 € | 2.750,00 € | | | |
| Sprayhood, stainless steel, 3 windows - DARK GREY | 2.090,00 € | 2.090,00 € | 1 | 0,00% | 2.090,00 € | 2.090,00 € | | | |
| Sunbed cushions on coach roof - DARK GREY | 1.200,00 € | 1.200,00 € | 1 | 0,00% | 1.200,00 € | 1.200,00 € | | | |
| Quick chain counter and anchor windlass control unit and instalation | 480,00 € | 480,00 € | 1 | 0,00% | 480,00 € | 480,00 € | | | |
| LCD TV 32" on fwd bulkhead + Glomex antenne (including installation and materials) | 850,00 € | 850,00 € | 1 | 0,00% | 850,00 € | 850,00 € | | | |
| Coffee machine (230V) | 360,00 € | 360,00 € | 1 | 0,00% | 360,00 € | 360,00 € | | | |
| FUSION Radio with bluetooth and 4 speakers(saloon and cockpit) + cockpit remote | 1.240,00 € | 1.240,00 € | 1 | 0,00% | 1.240,00 € | 1.240,00 € | | | |
| Charter equipment (deck, safety, bedlinen, galley, navigational...) | 6.800,00 € | 6.800,00 € | 1 | 0,00% | 6.800,00 € | 6.800,00 € | | | |
| Charter make-ready pack(Jib UV protect, auto switch for windlass, various reinforcement...) | 1.250,00 € | 1.250,00 € | 1 | 0,00% | 1.250,00 € | 1.250,00 € | | | |
| JABSCO electrical toilet pumps, sea water flush in B3, C2, D1(3 pcs) | 1.680,00 € | 2.040,00 € | 1 | 0,00% | 2.040,00 € | 2.040,00 € | | | |
| Folding passarelle | 860,00 € | 860,00 € | 1 | 0,00% | 860,00 € | 860,00 € | | | |
| A2 crew cabin with 2 bunk beds, sink and marine toilette | 3.650,00 € | 3.650,00 € | 1 | 0,00% | 3.650,00 € | 3.650,00 € | | | |
| LIST PRICE: | | | | | | | | 661.360,00 € | 661.360,00 € |
| TOTAL DISCOUNT: | | | | | | | | 117.475,60 € | 117.475,60 € |
| TOTAL PRICE: | | | | | | | | 543.884,40 € | 543.884,40 € |

| Notes: | |
|---------------------|--|
| Payment conditions: | 40.000 € + VAT upon order 90.000 € + VAT latest 12 weeks before start of production Balance latest three weeks before delivery |
| Payment method: | IBAN: HR46 2407 0001 1004 8508 0 SWIFT: OTPVHR2X at OTP Banka Hrvatska d.d. |
| Delivery: | |
| Offer valid till: | October 30th 2020 |
| Additional notes: | VAT is not included! The offer is valid for Croatia Yachting charter management fleet only! The boat will be displayed at the CBS and BBS 2021 |

(Date) _____ (Place) _____

(Signature)

www.hanseyachts.com



Hanse
BREAKING RULES . SETTING TRENDS