

HANSE

588



Hanse 588 - CHARTER EDITION

regular price 613.630 EUR

504.657 EUR*

FULLY EQUIPPED FOR CHARTER

SAVING: 108.972 EUR

Estimated yearly charter management profit: 66.070 €

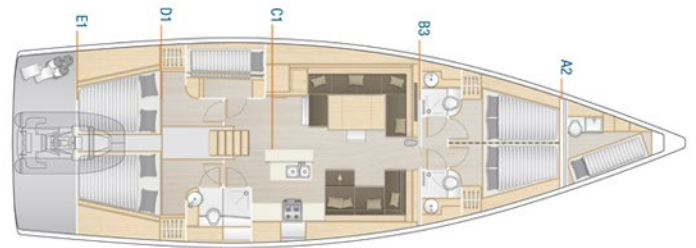

VALID TILL 31.08.2018.

- * The prices do not include VAT
- * The above indicated prices are valid only if the charter management contract is signed (minimum two years period)
- * Only valid for next available slot
- * No refund if single options from pack is not taken
- * Boat has to be taken over and paid in full after completion of the boat (if boat is not paid in time, discount will be recharged)

See full yacht specification below

CROATIA YACHTING D.O.O.

Split | tel: +385 (21) 332 332 | sales@hanseyachts.hr

Hanse
BREAKING RULES . SETTING TRENDS

www.hanseyachts.hr

OFFER

HANSE **588**

Dealer:	Croatia Yachting d.o.o.	Offer no.		Language:	English
	Dražanac 2/a, 21 000 Split, Croatia	Subject	Hanse 588 Charter Edition CM	Currency:	€
	EU VAT ID: HR08633766175	Hull no.		Exchange rate:	1
Customer:		Engine type		VAT:	0%
		Engine no.		Discount:	8.00%
		Length		Add. Discount:	0.00%
Date:		Year		Total Discount:	8.00%

MatNr	Items	Standard	Options	Add-On	Feature	Price ex. VAT €	Price ex. VAT €	Selectio n	Discount	Price ex VAT incl. Discount €	Price incl. VAT & Discount €
H588.19	as per standard specification					434,900.00 €	434,900.00 €	1	8.00%	400,108.00 €	400,108.00 €
	Packages										
XW2000	B&G Navigation Package					14,950.00 €	14,950.00 €	1	100.00%	0.00 €	0.00 €
XF2000	2 instrument pods (1 per helm station)							1	100.00%		
XF2200	2 B&G Triton² multifunction displays in cockpit, incl. transducer							1	100.00%		
XF2213	2 B&G Triton² multifunction displays, 1 per helm station (only with XF2000)							1	100.00%		
XF3000	B&G VHF V50 at chart table, incl. wireless remote handset H50 (only with XK5000 or XK5011)							1	100.00%		
XF4030	2 B&G Zeus³ 9" chart plotter, 1 per helm station							1	100.00%		
XF5000	B&G Autopilot with Triton² control unit and Precision 9 compass							1	100.00%		
XK5000	VHF preparation with antenna and splitter for FM and AIS							1	100.00%		
XW3000	Cruising Package					18,490.00 €	18,490.00 €	1	100.00%	0.00 €	0.00 €
XC9032	Courtesy lights in cockpit							1	100.00%		
XC9062	Helmsman footrests (free mountable)							1	100.00%		
XC9080	4 additional cleats, midship, retractable (2 each side)							1	100.00%		
XC9100	Delta-anchor 40 kg, galvanized with 60 m galvanized chain, dia. 10 mm							1	100.00%		
XE1102	Backstay tensioner, hydraulic							1	100.00%		
XG3101	Bowthruster, 24 V, retractable, incl. battery							1	100.00%		
XH1001	Battery set, capacity: 1x 90 Ah + 4x 160 Ah AGM							1	100.00%		
XH2201	Inverter/charger, 12 V / 2200 W - 100 A, incl. AC panel (only with XH1001)							1	100.00%		
XV9420	Wind indicator							1	100.00%		
XV9450	Flagpole							1	100.00%		
XV9901	8 fenders							1	100.00%		
XV9902	4 mooring lines							1	100.00%		
XV9910	Add. winch handle							1	8.00%		
XV9950	HANSE maintenance kit							1	8.00%		
XW5000	Comfort Package					9,690.00 €	9,690.00 €	1	100.00%	0.00 €	0.00 €
XC9051	Electrical deck wash pump, mounted in bow area with outlet on deck							1	100.00%		
XC9300	2 vents for coach roof hatches							1	100.00%		
XL9001	Courtesy lights in saloon							1	100.00%		
XL9003	Indirect lights in saloon and cabins							1	100.00%		
XL9004	LED overhead lights in saloon and cabins, dimmable							1	100.00%		
XL9010	SLS - Scenario light system - touch screen controller and dimmer in saloon and fwd cabin							1	100.00%		
XN2400	Sun bed cushions on coach roof (colour selection)							1	100.00%		
XN2500	Cockpit cushions (colour selection)							1	100.00%		
XN2503	Cushion for helmsman seats (colour selection)							1	100.00%		
XV9010	Blind set with flyscreens for deck hatches							1	100.00%		
XV9060	Blinds for hull windows							1	100.00%		
XV9080	Blinds for side coach roof windows							1	100.00%		
	OPTIONS										
	HULL										
	KEEL										
XB9000	Keel and rudder - not mounted			X		890.00 €	890.00 €	1	100.00%	0.00 €	0.00 €
	LAYOUT & INTERIOR										
XL2003	B3: 2 fwd cabins with double berth, storage space and separate head with shower - convertible by a removable bulkhead into a single cabin			X		6,040.00 €	6,040.00 €	1	100.00%	0.00 €	0.00 €
XL7001	Saloon table electrically lowerable with cushions, convertible into double berth			X		2,350.00 €	2,350.00 €	1	100.00%	0.00 €	0.00 €
	WOOD (FURNITURE, FLOORBOARD)										
XM1201	Floorboard - Classic Stripes			X		1,950.00 €	1,950.00 €	1	8.00%	1,794.00 €	1,794.00 €
	UPHOLSTERY, CARPETS & CURTAINS										
XN2001	Upholstery - Monte Carlo (colour selection)			X		490.00 €	490.00 €	1	100.00%	0.00 €	0.00 €
	DECK & OUTSIDE EQUIPMENT										
XC1300	Teak on side deck			X		18,900.00 €	18,900.00 €	1	8.00%	17,388.00 €	17,388.00 €
XC1310	Teak on coach roof			X		5,950.00 €	5,950.00 €	1	8.00%	5,474.00 €	5,474.00 €
XC1333	Teak on helmsman seats (only with XC9060)			X		standard	0.00 €	1	8.00%	0.00 €	0.00 €
XC3004	2 cockpit tables, aluminium foot with teak tops, electrically lowerable into sunbed incl. upholstery			X		3,900.00 €	3,900.00 €	1	100.00%	0.00 €	0.00 €
XC5102	2 LEWMAR 65 EST EVO electrical halyard winches (only with XH1001)			X		7,500.00 €	7,500.00 €	1	8.00%	6,900.00 €	6,900.00 €
XC9060	2 helmsman seats, foldable (only with XC1333 or XC1334)			X		1,800.00 €	1,800.00 €	1	100.00%	0.00 €	0.00 €
	RIG & SAILS										
XE2012	Sprayhood with stainless steel stake, 3 windows (1 openable - colour selection - not with XE2009 or XE2010 or XE2051 or XE2052 or XE2053)			X		2,950.00 €	2,950.00 €	1	100.00%	0.00 €	0.00 €
XE2021	Bimini with stainless steel stake (colour selection - not with XE2051, XE2052 and XE2053)			X		3,950.00 €	3,950.00 €	1	100.00%	0.00 €	0.00 €
	NAVIGATION & INSTRUMENTS										
	PROPULSION										
	EQUIPMENT										
XH2102	Generator 10000i, 8,0 kW / 0 - 9,0 kVA incl. maintenance kit			X		19,990.00 €	19,990.00 €	1	8.00%	18,390.80 €	18,390.80 €
XH4511	Air conditioning, 40.000 BTU, 4 units: 2 saloon, fwd cabin, aft cabin, incl. 2nd shore power (not with XH4100)			X		19,900.00 €	19,900.00 €	1	8.00%	18,308.00 €	18,308.00 €
XH5101	Additional freezer in saloon (not with XH5100 and XH5112 - only with XH1001)			X		1,450.00 €	1,450.00 €	1	100.00%	0.00 €	0.00 €
	RADIO & ENTERTAINMENT										
	ACCESSORIES										
	SHIPPING AND TRANSPORT										
XZ2001	Loading on truck			X		650.00 €	650.00 €	1	100.00%	0.00 €	0.00 €
XZ4000	Declaration of Conformity			X	Croatian	standard	0.00 €	1	8.00%	0.00 €	0.00 €
XZ4005	Safety manual			X		standard	0.00 €	1	8.00%	0.00 €	0.00 €

XZ4010	Builder's Certificate	X	standard	0.00 €	1	8.00%	0.00 €	0.00 €
LIST PRICE:							576,690.00 €	576,690.00 €
TOTAL DISCOUNT:							18.78%	108,327.20 €
TOTAL PRICE:							468,362.80 €	468,362.80 €

Additional components:		Price ex VAT							
Transport Greifswald - Umag				11,450.00 €	11,450.00 €	1	0.00%	11,450.00 €	11,450.00 €
Rigging (mast assembly and installation, installation of sails and rails)				1,680.00 €	1,680.00 €	1	10.00%	1,512.00 €	1,512.00 €
Antifouling (including materials - 2 layers of primer and antifouling)				1,770.00 €	1,770.00 €	1	10.00%	1,593.00 €	1,593.00 €
Costs of launching (including travel lift, 5 days land berth charges, 1 day sea berth)				2,360.00 €	2,360.00 €	1	0.00%	2,360.00 €	2,360.00 €
Final commissioning - test of equipment, Engine pre-delivery inspection, calibration of nav. instruments, cleaning				600.00 €	600.00 €	1	50.00%	300.00 €	300.00 €
Keel and rudder installation				1,050.00 €	1,050.00 €	1	0.00%	1,050.00 €	1,050.00 €
Lazy bag with lazy jacks - DARK GREY				920.00 €	920.00 €	1	0.00%	920.00 €	920.00 €
Quick chain counter and anchor windlass control unit and instalation				450.00 €	450.00 €	1	0.00%	450.00 €	450.00 €
LCD TV 32" on fwd bulkhead + Glomex antenne (including installation and materials)				850.00 €	850.00 €	1	0.00%	850.00 €	850.00 €
Coffee machine (230V)				360.00 €	360.00 €	1	0.00%	360.00 €	360.00 €
Radio CD(MP3/USB) player with saloon and cockpit speakers				650.00 €	650.00 €	1	0.00%	650.00 €	650.00 €
Charter equipment (deck, safety, bedlinen, galley, navigational...)				6,800.00 €	6,800.00 €	1	0.00%	6,800.00 €	6,800.00 €
Charter make-ready pack(Jib UV protect, auto switch for windlass, various				1,250.00 €	1,250.00 €	1	0.00%	1,250.00 €	1,250.00 €
JABSCO electrical toilet pumps, sea water flush in B3, C2, D2(4 pcs)				2,240.00 €	2,240.00 €	1	0.00%	2,240.00 €	2,240.00 €
Folding passarelle				860.00 €	860.00 €	1	0.00%	860.00 €	860.00 €
A2 crew cabin with 2 bunk beds, sink and marine toilette				3,650.00 €	3,650.00 €	1	0.00%	3,650.00 €	3,650.00 €
LIST PRICE:							613,630.00 €	613,630.00 €	
TOTAL DISCOUNT:							108,972.20 €	108,972.20 €	
TOTAL PRICE:							504,657.80 €	504,657.80 €	

Notes:

Payment conditions:

30.000 € + VAT upon order
85.000 € + VAT 12 weeks before production start
Balance latest three weeks before delivery

Payment method:

IBAN: HR30 2330 0031 1530 4592 3, SWIFT: SOGEHR22 at SPLITSKA BANKA d.d.

Delivery:

Offer valid till:

7 days

Additional notes:

VAT is not included!
The offer is valid for Croatia Yachting charter management fleet only!

(Date)

(Place)

(Signature)

www.hanseyachts.com

Hanse
BREAKING RULES . SETTING TRENDS